



How to reach us

You can easily reach our clinics by car or public transportation. It takes about 40 minutes by car from the airport and about 60 minutes by urban railway/subway, from the main train station about 15 minutes.



Klinikum Großhadern, Marchioninistr. 15, 81377 Munich

Travelling by car

Coming from Munich airport: Take the "Autobahn" to Munich and change at junction to A92 in direction Munich-West/Stuttgart. After about 20 km at junction München-Feldmoching change to A99, go on for about 18 km until you pass the junction "Autobahn-Dreieck München-Süd-West". Take the A96 in direction Munich Centre until exit „Blumenau“, proceed in direction "Großhadern". After about 500 m the Marchioninistraße is on your right hand side.

Coming from other directions: Follow "Mittlerer Ring West". At the junction "München-Sendling" proceed to Autobahn A96 in direction Stuttgart. Leave at exit "Blumenau" and proceed in direction "Großhadern". After about 500 m the Marchioninistraße is on your right hand sight.

At the University Hospital Großhadern, there are free parking spaces available for visitors and patients.

Travelling by public transportation

The main entrance of hospital is located at the terminal stop of subway line U6 and is served by the following bus lines: 266, 269 (bus stop "Max-Lebsche-Platz") and MetroBus 56 (bus stop "Klinikum Ost").

For detailed information and schedules please refer to www.mvv-muenchen.de

Cardiac Surgery Polyclinic and Wards

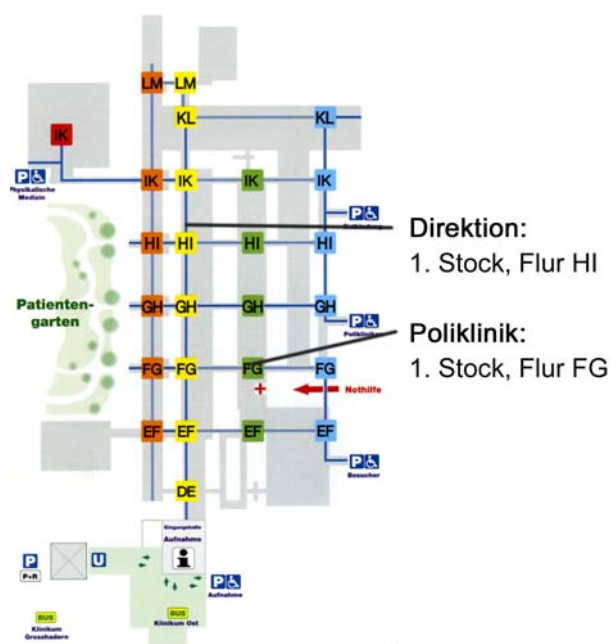

When you enter via main entrance, the Director's office is located on Level 1, between blocks "HI" and "IK"; the outpatient registration offices and polyclinic are situated on floor "FG".

The inpatient area is located on Ward G3, Level 3 (please use elevator or stairways at yellow sign FG), the Intensive Care Unit H3A (Level 3, access via Ward G3) and the Paediatric Ward G9 on Level 9. The Private Patients' Ward I21 is situated on Level 0, block HI.

Cardiology Clinic at Augustinum, Wolkerweg 16, 81375 Munich

We recommend using public transportation or taxi service as parking is restricted around the Augustinum building and only very few parking spaces are available.

Travelling by car

When you arrive via A96 take exit „Laim“, proceed northbound into Fürstenrieder Straße. At junction „Guardinistraße“ turn left, proceed until „Stiftsbogen“. Turn right into „Wolkerweg“.

When entering via „Mittlerer Ring West“ (Garmischer Straße) please turn westbound into „Ehrwalder Straße“. Proceed until „Stiftsbogen“ and then turn right into „Wolkerweg“.

Travelling by public transportation

Subway: Use line U6 to "Klinikum Großhadern" and leave at the station "Haderner Stern". From here it is just a 5 minute walk to the Cardiology Clinic at Augustinum.

Tram: Use line 18 until terminal station „Gondrellplatz“. Then it is only a 2 minute walk to the Cardiology Clinic at Augustinum.